

Swivel

75WP



For drilling medium depth oil wells - for deep slim hole drilling - for the heavier work-over rigs - for drilling deep water wells

This swivel is sturdier than the other types of King Swivels, but like those other types it has a very high ratio of capacity to weight.

Foreign operators should find this swivel attractive because it can be more readily transported than other, heavier swivels having comparable capacity.

The 75WP Swivel is available with the conventional bail, or it will be furnished with an elevator shank in lieu of a bail.

Alloy steel is used throughout in the manufacture of this swivel, except that some minor parts are of bronze where that metal is more suitable.

The bearings are angular-contact type ball bearings. The thrust bearing is a unit of four bearings mounted tandem. These bearings are flush ground and matched at the factory to assure that each bearing will carry its share of the load. Reverse loads are absorbed by a single angular-contact bearing mounted opposed to the main thrust unit. The manner in which the bearings are mounted will provide ample radial stability for the swivel.

The swivel housing is provided with automatic grease seals. These seals retain the bearing lubricant. A good grade of ball bearing grease should be injected, with a grease gun, once or twice per location.

The packing unit consists of stuffing box, washpipe, Chevron V-Type packing, O-Rings, lantern rings and packing gland with zerk grease fitting which simplifies packing lubrication. The packing is quickly and easily adjusted by tightening the bronze adjusting ring. Repacking can be accomplished in a few minutes by this six-step procedure:

1. Rotate packing box to align with square on washpipe, raise packing box over washpipe squares, then rotate packing box (6) six turns to right to disengage washpipe.
2. Remove adjusting ring and unscrew washpipe.
3. Remove complete packing unit and washpipe.
4. Replace seat, packing, lantern rings and gland.
5. Replace washpipe and insert packing box with packing assembly.
6. Replace adjusting ring.

Weight and Dimensional Data

Type Swivel	Weight	Length	Width	Bail Opening
75WP with 4 1/2" Connection	740 lbs.	65"	11 1/4"	8" x 18"
75WP with 6 5/8" Connection	800 lbs.	66"	11 1/4"	8" x 18"

Type Swivel	Kelly Connection	Hose Connection	Inside Diameter Watercourse	Weight Boxed For Export
75WP with 4 1/2" Connection	4 1/2" API-LH	3" NPT	2 1/2"	920 lbs.
75WP with 6 5/8" Connection	6 5/8" API-LH	3" NPT	2 1/2"	980 lbs.

Capacity and Safety Data

Capacity, lbs. at 100 R.P.M.	Safe Load Limits, lbs.	2 7/8"	Safe Depths (Feet) with Drill Pipe 3 1/2"	4 1/2"
100,000	250,000	10.40 lbs. 9,200'	13.30 lbs. 6,000'	16.60 lbs. 5,000'

Swivel

75WP

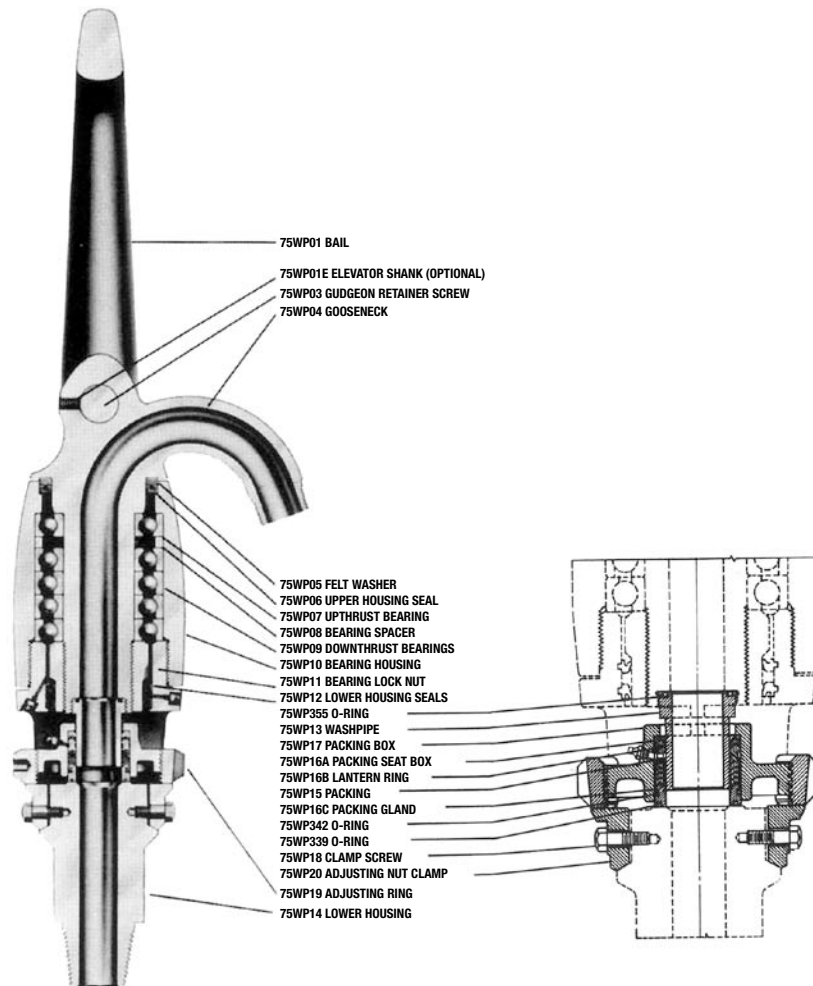

Parts List for 75WP Swivel

Part Number	Name of Part	Number Required	Net Weight Pounds	Spares for One Year Service
75WP	Swivel with 4 1/2" Pin Complete	..	740	
75WP	Swivel with 6 5/8" Pin Complete	..	800	
N75WP01A	Bail	1	126	
N75WP01E	Elevator Shank	1	135	
N75WP02	Bail Gudgeon Pin	1	13	
N75WP03	Gudgeon Retainer Screw	2	1/8 (2)	
N75WP04A	Gooseneck	1	166	
N75WP05	Felt Washer	1	1/16	1
N75WP06	Upper Housing Seal	1	3/4	1
N75WP07	Bearing	5	14	1
N75WP08	Bearing Spacer	1	3	1
N75WP10	Bearing Housing	1	134	
N75WP11	Bearing Adjust Nut	1	17	
N75WP12	Lower Housing Seal	2	1/2 (2)	2
N75WP13	Washpipe	1	4	5
N75WP335	O-Ring	1	1/16	2
N75WP14	Lower Housing	1	149	
N75WP15	Packing	1 set	1/2	10 sets
N75WP16A	Packing Seat Ring	1	1/2	2
N75WP16B	Lantern Ring	1	1	2
N75WP16C	Packing Gland	1	1 1/2	2
N75WP17	Packing Box	1	13	1
N75WP18	Clamp Screw	4	1 (4)	2
N75WP19	Adjusting Ring	1	17 1/3	1
N75WP339	O-Ring	1	1/16	2
N75WP20	Adjusting Nut Clamp	2	2 (2)	...
N75WP342	O-Ring	1	1/16	2

* When ordering Swivel with Elevator Shank, state size of elevator. Downthrust Bearings should always be replaced with a full matched set.
 ** Never renew one or two bearings in an old set.