

Elevator Link Weight & Dimensional Data

Elevator Links

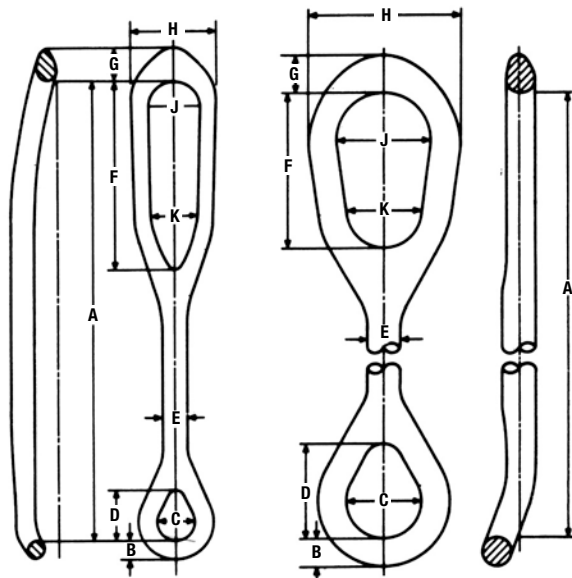

King Oil Tool's forged steel alloy elevator links are especially designed for long life and safety.

Each weldless link is forged from a single steel billet, heat treated for strength and durability and magnafluxed for integrity, then matched in sets to maintain elevator balance. Links 3 1/2" by 2 3/4" are designed for intermediate to deep drilling and workover, rated 500 ton and 350 ton per set.

Links rated at 250 tons are available in 2 1/4" stock in two-lengths – 108" for drilling and 96" for workover. Rated at 150 tons per set, 1 3/4" links are available in 84", 72", 60", 48" and 36" lengths for shallow drilling, tubing work and portable rigs.

Links rated at 65 tons per set are furnished in 1 1/2" stock and 36" and 30" lengths for water well drilling, mineral exploration and shallow drilling.

Dimensions (in inches)

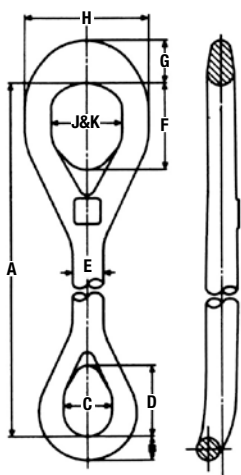

| Size Dimensions | 2 3/4 x 132 | 2 3/4 x 108 | 2 3/4 x 96 | 2 1/4 x 108 | 2 1/4 x 96 | 1 3/4 x 84 | 1 3/4 x 72 | 1 3/4 x 60 | 1 3/4 x 48 | 1 3/4 x 36 |
|-------------------|-------------|-------------|------------|-------------|------------|------------|------------|------------|------------|------------|
| A | 132 | 108 | 96 | 108 | 96 | 84 | 72 | 60 | 48 | 36 |
| B | 2 3/4 | 2 3/4 | 2 3/4 | 2 1/4 | 2 1/4 | 1 3/4 | 1 3/4 | 1 3/4 | 1 3/4 | 1 3/4 |
| C | 5 1/2 | 5 1/2 | 5 1/2 | 5 1/2 | 5 1/2 | 4 | 4 | 4 | 4 | 4 |
| D | 8 | 8 | 8 | 8 | 8 | 6 | 6 | 6 | 6 | 6 |
| E | 3 1/2 | 3 1/2 | 3 1/2 | 2 7/8 | 2 7/8 | 2 7/8 | 2 7/8 | 2 7/8 | 2 7/8 | 2 7/8 |
| F | 10 | 10 | 10 | 10 | 10 | 13 1/8 | 13 1/8 | 13 1/8 | 13 1/8 | 13 1/8 |
| G | 5 | 5 | 5 | 5 | 5 | 3 9/16 | 3 9/16 | 3 9/16 | 3 9/16 | 3 9/16 |
| H | 14 | 14 | 14 | 14 | 14 | 8 3/4 | 8 3/4 | 8 3/4 | 8 3/4 | 8 3/4 |
| J | 8 | 8 | 8 | 8 | 8 | 5 | 5 | 5 | 5 | 5 |
| K | 8 | 8 | 8 | 8 | 8 | 3 1/2 | 3 1/2 | 3 1/2 | 3 1/2 | 3 1/2 |
| Wt. Lbs. Per Set | 1,000 | 870 | 800 | 610 | 550 | 330 | 290 | 245 | 245 | 165 |
| Rates Ton Per Set | 350 | 350 | 350 | 250 | 250 | 150 | 150 | 150 | 150 | 150 |

Additional lengths and sizes available on request.

Wear Capacity

3 1/2", 2 3/4" & 2 1/4" SIZE

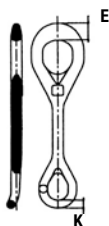

| Upper Eye Link Size | | | | | | | | | | Lower Eye Link Size | | | | | | | | | |
|---------------------|------|---------|------|-------|------|-------|------|-------|------|---------------------|------|---------|------|--------|------|--------|------|-------|------|
| 1 1/2 | | 1 3/4 | | 2 1/4 | | 2 3/4 | | 3 1/2 | | 1 1/2 | | 1 3/4 | | 2 1/4 | | 2 3/4 | | 3 1/2 | |
| Dim E | | Dim E | | Dim E | | Dim E | | Dim E | | Dim K | | Dim K | | Dim K | | Dim K | | Dim K | |
| In | Tons | In | Tons | In | Tons | In | Tons | In | Tons | In | Tons | In | Tons | In | Tons | In | Tons | In | Tons |
| 2 | 65 | 1 7/8 | 150 | 5 | 250 | 5 | 350 | 6 | 500 | 1 1/2 | 65 | 1 3/4 | 150 | 2 1/4 | 250 | 2 3/4 | 350 | 3 1/2 | 500 |
| 1 5/16 | 57 | 1 13/16 | 129 | 4 3/4 | 250 | 4 3/4 | 298 | 5 3/4 | 430 | 1 7/16 | 59 | 1 5/8 | 130 | 2 1/8 | 220 | 2 5/8 | 319 | 3 3/8 | 465 |
| 1 7/8 | 55 | 1 3/4 | 125 | 4 1/2 | 250 | 4 1/2 | 280 | 5 1/2 | 410 | 1 3/8 | 55 | 1 9/16 | 120 | 2 1/16 | 210 | 2 1/2 | 290 | 3 1/4 | 430 |
| 1 3/4 | 50 | 1 5/8 | 116 | 4 1/4 | 250 | 4 1/4 | 263 | 5 1/4 | 385 | 1 5/16 | 49 | 1 17/32 | 114 | 2 | 198 | 2 3/8 | 250 | 3 1/8 | 395 |
| 1 5/8 | 46 | 1 1/2 | 105 | 4 | 245 | 4 | 245 | 5 | 365 | 1 1/4 | 45 | 1 1/2 | 111 | 1 7/8 | 173 | 2 5/16 | 245 | 3 | 365 |